

- HOSEBED CAPACITIES
- ① 1500' OF 2.50" D.J. POLYESTER HOSE
  - ② 400' OF 1.50" D.J. POLYESTER HOSE
- (1) 0.25" SINGLE SHEET HOSEBED DIVIDER

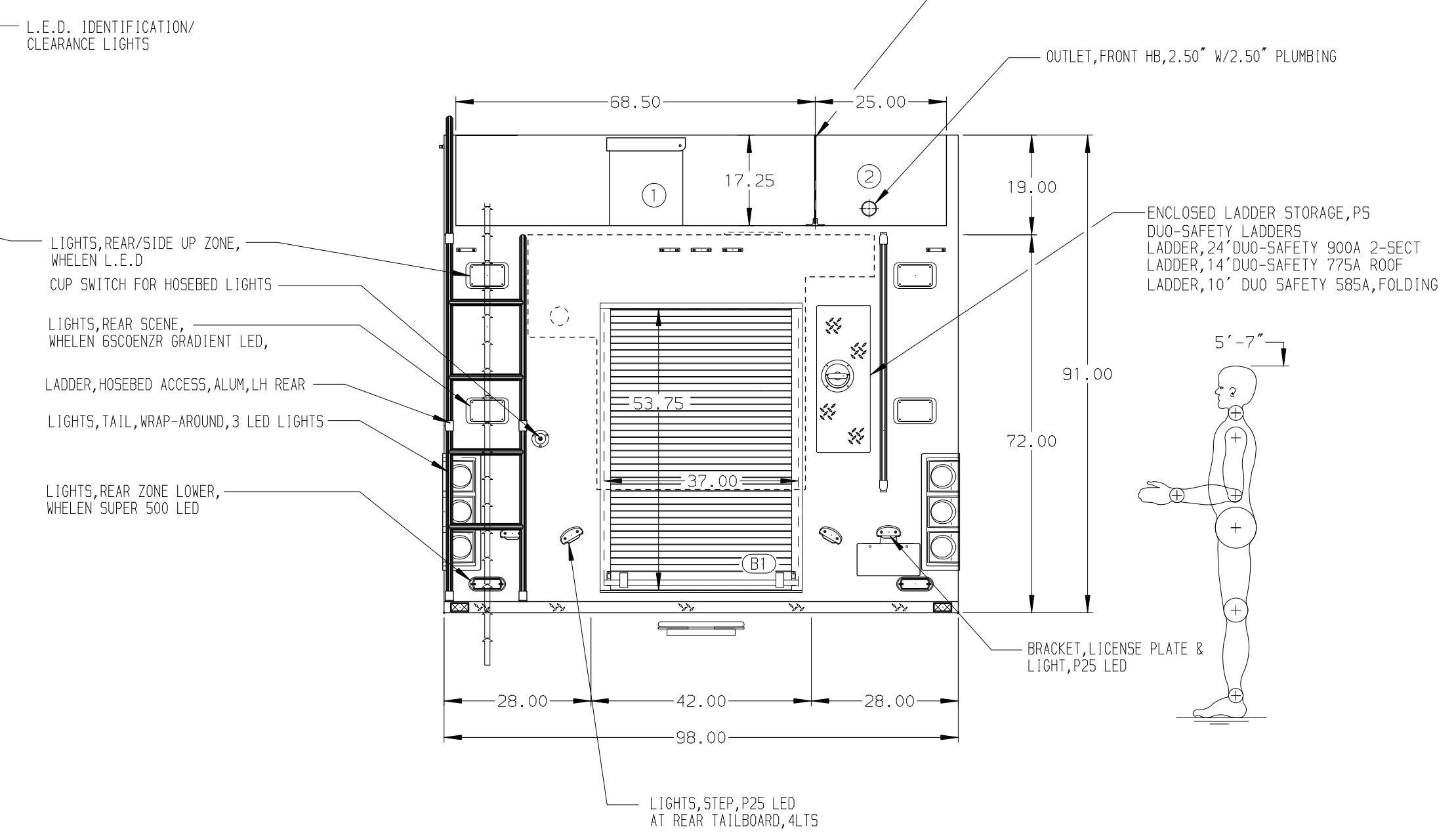
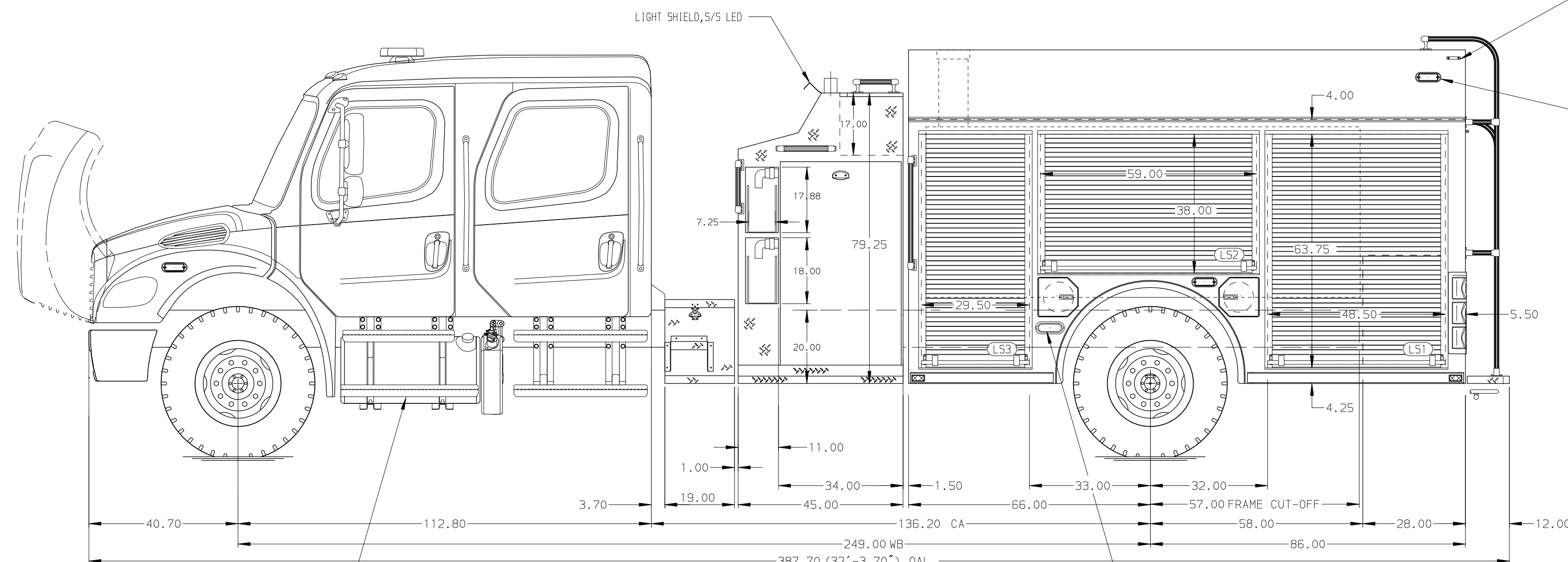

**ALUMINUM BODY**

**NOTE**  
DIMENSIONS SHOWN ARE APPROXIMATE AND ARE SUBJECT TO MINOR DEVIATIONS AS MAY OCCUR OR BE NECESSARY IN CONSTRUCTION. MINOR DETAILS NOT SHOWN.

1. C/F WHEEL CHOCKS AND MOUNTING BRACKETS
2. EXHAUST SYSTEM, HORIZONTAL, RH STEP MOUNTED DPF/SCR, 2013 FL
3. PERIMETER SCENE LIGHTS LOCATED PER SHOP ORDER
4. BATTERY CHARGING RECEPTACLE LOCATED ON THE DRIVER SIDE PUMP PANEL
5. AIR INLET LOCATED LOCATED DS PUMP PANEL
6. CONCEPTUAL DRAWING STAGE

				<b>PIERCE MANUFACTURING INC.</b> BRADENTON, FLORIDA		JOB NO.	SF-1208
						SCALE	DATE
				TITLE 1000 GAL WATER, 152" FULL HT FRONT & REAR 3/4" TOP MOUNT PH, (2) SPEEDLAYS & LADDERS THRU BODY FOR PIERCE MANUFACTURING INC. BRADENTON, FLORIDA		DRAWN BY	04JUN20
						CHECKED BY	5JUN20
				DWG NO. SF-1208AD		SHEET SIZE	SHEET NO.
REV	DATE	BY	CH	M2-106		D	1 OF 1